



High Speed P/T/Z 36x Dome Camera

CM-SD513
CM-SD563

Feature

- 1/4" SONY Ex-View Total Solution
- 36x Optical Zoom
- Faster Focus / Auto iris / Enhanced Picture Quality
- Min. illumination 0.01 lux
- Removable IR CUT FILTER built-in for DAY & NIGHT Usage
- Fan and Heater built-in (OUTDOOR TYPE ONLY)
- ID Adjustable from OSD Menu
- 137 Preset Positions
(Include 4 Groups, 16 Preset Points in a Group)
- X / Y Position Display
- RS-485 Interface
- Both Pelco P and Pelco D Protocol Embedded



Indoor
CM-SD513



Outdoor
CM-SD563

Specification

Model	CM-SD513	CM-SD563
Type	Indoor	Outdoor
Day & Night	Auto IR Cut	
System	NTSC / PAL	
Image Sensor	1/4" Ex-View CCD	
Effective Pixel	Approx. 380,000 pixels (NTSC) / Approx. 440,000 pixels (PAL)	
Lens	36X optical zoom, f=3.4mm(wide) to 122.4mm (tele), F1.6 to F4.5	
Digital Zoom (Total)	12X (432X with optical zoom)	
Angle of View (H)	57.8°(wide end) to 1.7°(tèle end)	
Object Distance	320mm (wide end) to 1500mm (tele end)	
Sync. System	Internal/External (V-lock)	
Min. Illumination	1.4 lux / 1/60sec. (NTSC), 1/50 sec. (PAL) (Typical value); 0.1 lux/1/4sec (NTSC), 1/3sec.(PAL)(Typical value); ICR-ON Mode: 0.01 lux / 1/4sec.(NTSC), 1/3sec.(PAL)	
Resolution	NTSC: 470 TV lines(WIDE end)	PAL: 460 TV lines(WIDE end)
S/N Ratio	More than 48dB (AGC OFF)	
Electronic Shutter	1/4(1/3) to 10000sec.	
White Balance	Auto, ATW, indoor, outdoor, one push, manual	
Gain	Auto/ Manual (-3 to 28dB, 2dB steps)	
AE Control	Auto, manual, priority mode, bright, EV compensation, back light compensation, slow AE	
BLC	Auto/ Manual	
Cam. Operation Switch	Auto (Sensitive:H,L), On-Push AF, Zoom Trigger AF	
Pan	360° continuous	
Tilt	0° ~ 90°	
Pan/ Tilt Accuracy	± 0.3°	
Manual Pan/ Tilt Speed	0.3~ 120 /sec.	
Preset Position	137 positions	
Instant Flip	180°	
Preset Recall Speed	150°/sec.	
Address Setting	1 ~ 64	
Control Interface	RS-485	
Cable Requirement	UL 24AWG x 2C Twist Pair (recommend)	
Power	DC 12V or DC13.5V	
Weight	N.W/G.W.:2.9kg / 3.6kg	N.W/G.W.: 3.3kg / 4kg
Dimension	229(W) x 245(H)mm	214(W) x 238(H)mm
Operating Temp.	-20~ + 50 °C (-4 to 122 F°)	
Certification	CE / FCC	

Dimension

CM-SD563

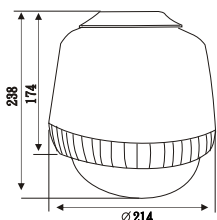

CM-SD513

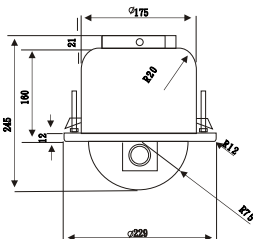

CM-PS17



CM-PS18



CM-PS19

