

1/3" Sony High Resolution Vari-Focal Lens Dome Camera

CM-D1050 (Vandal Proof)
CM-D1080

Feature

- 1/3" SONY HQ1 Total Solution
- 530 TV Lines of High Horizontal Resolution
- Built-in Vari-Focal / DC Iris Lens
- Lightness, Compact, Solid-Stage Body Design (CM-D1080)
- Vandal Proof Design for Long Durability (CM-D1050)
- Class IP66 Weatherproof (CM-D1050)



CM-D1050 (Vandal Proof)



CM-D1080

Specification

General	CM-D1050 (Vandal Proof)	CM-D1080
Pick up device	1/3" interline transfer CCD	1/3" interline transfer CCD
Total Pixels	NTSC:811(H) x 508(V) / PAL:795(H) x 596(V)	NTSC:811(H) x 508(V) / PAL:795(H) x 596(V)
Effective Pixels	NTSC:768(H) x 494(V) / PAL:752(H) x 582(V)	NTSC:768(H) x 494(V) / PAL:752(H) x 582(V)
Resolution	530 TV lines	530 TV lines
Sync. System	2: Internal	2:1 Internal
Scanning System	NTSC: 525 Lines / 60 Fields ; PAL: 625 Lines / 50 Fields	NTSC: 525 Lines / 60 Fields ; PAL: 625 Lines / 50 Fields
S/N Ratio	More than 48 dB (AGC OFF)	More than 48 dB (AGC OFF)
Electronic Shutter	Auto 1/60 (1/50) ~1/100,000 sec.	Auto 1/60 (1/50) ~1/100,000 sec.
Min. Illumination	0.5 lux F2.0	0.5 lux / F2.0
Video Output	1.0 Vp-p / 75 ohm composite	1.0 Vp-p / 75 ohm composite
White Balance	Auto	Auto
Automatic Gain Control	ON	ON
Lens		
Lens Type	DC Vari-Focal Lens	DC Vari-Focal Lens
Electrical		
DC power Source	DC12V	DC12V
Power Consumption	2W (Max)	2W (Max)
Current	170mA (Max)	170mA (Max)
Weight	N.W./G.W.: 0.86kg / 0.94kg	N.W. / G.W.: 0.31kg / 0.44kg
Dimension	130(Diameter) x 100(H)mm	138(Diameter) x 103(H)mm
Operation Temperature	-10 to 50°C (14 to 122°F)	-10 to 50°C (14 to 122°F)
Storage Temperature	-20 to 70°C (-4 to 158 °F)	-20 to 70°C (-4 to 158 °F)
Certification	CE / FCC	CE / FCC

Dimension

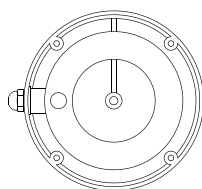
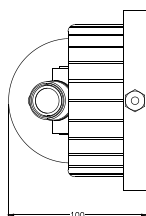
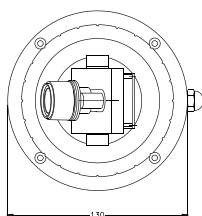

CM-D1050

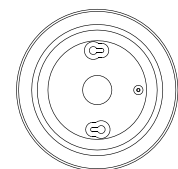
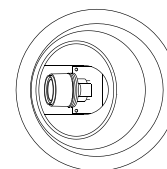
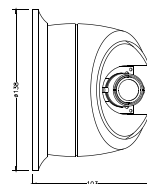

CM-D1080